

Pro-Torch™ TIG Torches



Premium Air-Cooled and Water-Cooled Models

Light and easy to use, these torches give you the power of maximum versatility and maneuverability. A molded, knurled handle gives you a sure grip so you can focus on the weld. “F” model torches feature flexible heads to increase your comfort and get you into tighter spaces. “V” model torches provide a convenient gas control valve to turn off and on shielding gas at the torch. Available with several amperage ratings in both air-cooled and water-cooled versions. Whether you are an occasional TIG welder, fabrication shop or production welder, one of the Pro-Torch TIG torches is right for you.

Processes

TIG

Advantage Lincoln

- Choose between a wide range of both air-cooled and water-cooled torches in various amperage ranges to meet the performance needs of the professional.
- Select “F” model torches feature flexible heads for significantly greater comfort and access to tight spaces.
- Select “V” model torches have a convenient gas control valve on the torch to quickly and easily control the shielding gas flow when a gas solenoid valve is not “built-in” to the power source.
- **NEW!** Select models available with new Ultra-Flex™ Cables for ultimate comfort and maneuverability.
- Comfortable knurled handle for a non-slip sure grip for precise control of TIG Torch.

Advantage Lincoln

- Molded lip/ridge on the torch handle for easy connecting of a zippered cable cover. Allows cable cover to be securely attached to torch handle.
- All Pro-Torch TIG torches are made from the highest quality materials to assure high performance and long life.
- One year Lincoln warranty on torch.

Required Options

- Power Cable Adapters⁽¹⁾, Collets, Collet Bodies and Gas Lens Collet Bodies, Alumina Nozzles, Tungsten Electrode
- ⁽¹⁾ May be required for certain torch & power source combinations

Recommended General Options

TIG-Mate™ TIG Torch Starter Packs, Hook-Up Kit, Back Cap, Parts Kit, Hand Amptrol, Zippered Cable Cover

TECHNICAL SPECIFICATIONS				
Product Name	Rated Amps	Duty Cycle	Tungsten Range	Cable Lengths
<i>Air-Cooled Models</i>				
PTA-9 Standard Head	125	60%	.020 - 1/8" (0.5 - 3.2mm)	12.5 or 25 ft. (3.8 - 7.6m)
PTA-9F Flex Head				
PTA-9FV Flex Head w/ Valve				
PTA-17 Standard Head	150	60%	.020 - 5/32" (0.5 - 4.0mm)	12.5 or 25 ft. (3.8 - 7.6m)
PTA-17V Standard Head w/Valve				
PTA-17F Flex Head				
PTA-17FV Flex Head w/ Valve				
PTA-26 Standard Valve	200	60%	.020 - 5/32" (0.5 - 4.0mm)	12.5 or 25 ft. (3.8 - 7.6m)
PTA-26V Standard Head w/ Valve				
PTA-26F Flex Head				
PTA-26FV Flex Head w/ Valve				
<i>Water-Cooled Models</i>				
PTW-20 Standard Head	250	100%	.020 - 1/8" (0.5 - 3.2mm)	12.5 or 25 ft. (3.8 - 7.6m)
PTW-18 Standard Head	350	100%	.020 - 5/32" (0.5 - 4.0mm)	12.5 or 25 ft. (3.8 - 7.6m)

ADVANTAGE LINCOLN

Versatility

- Pro-Torch TIG torches are used for a variety of applications in power plant construction, job shops, tool and die work, construction sites and production plants.
- Expendable parts are also interchangeable with industry standard torches. Use the Industry Reference Numbers as a cross reference guide to order Lincoln premium replacement parts.

Gas Control Valve Models

Air-cooled torches are available with a gas control valve for use on machines without gas solenoids.

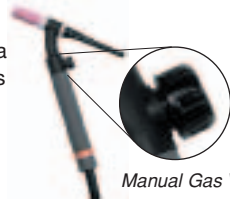

Manual Gas Valve

1-PC. Vs. 2-PC. Cable Ends

1-Piece cables consist of a power conductor inside a rubber hose. 2-Piece cables consist of a separate power conductor and a braided gas hose.



Flexible Head Models

Air-cooled torches are available with flexible heads for easy maneuverability in tight places. Models are also available with flexible heads and gas valves.



Maximum Durability

TIG torch bodies are made from copper conductors and silicon rubber insulation ensuring durability and long life.

NEW!

Ultra-Flex™ Cable Models

Select TIG torch models are available with the new Ultra-Flex power cable. The Ultra-Flex power cable provides over five times the flexibility compared to a standard power cable. The result is premium levels of comfort, ergonomics and maneuverability.

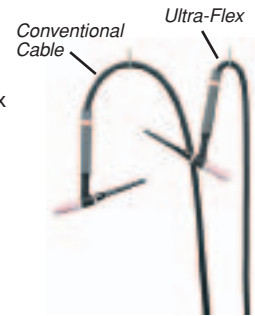

AVAILABLE TORCHES



PTA-9, PTA-9F and PTA-9FV

Air-cooled TIG torch, rated 125 amps at 60% duty cycle. The PTA-9F is equipped with a flexible head for easy maneuverability into tight places. The PTA-9FV is equipped with a gas valve for gas flow control, and a flexible head.



PTA-17, PTA-17V, PTA-17F and PTA-17FV

Air-cooled TIG torch, rated 150 amps at 60% duty cycle. The PTA-17V is equipped with a valve for gas flow control. The PTA-17F is equipped with a flexible head for easy maneuverability into tight spaces. The PTA-17FV is equipped with both a gas valve and a flexible head.



Ultra-Flex™ PTA-9F TIG Torch Package

This torch package includes a PTA-9F flex head torch with a 12.5' (3.8m) Ultra-Flex™ cable and K1622-1 Twist-Mate™ adapter. Also includes a 1/16" (1.6mm) gas lens collet body, collet and gas lens.
Order K1781-9



PTA-26, PTA-26V, PTA-26F and PTA-26FV

Air-cooled TIG torch, rated 200 amps at 60% duty cycle. The PTA-26V is equipped with a valve for gas flow control. The PTA-26F is equipped with a flexible head for easy maneuverability into tight spaces. The PTA-26FV is equipped with both a gas valve and flexible head.



Ultra-Flex™ PTA-26 Torch Package

This torch package includes a PTA-26 torch with a 12.5' (3.8m) Ultra-Flex cable and K1622-3 Twist-Mate adapter. Also includes a 1/8" (3.2mm) collet, collet body and gas nozzle.
Order K1783-12



PTW-20

Water-cooled TIG torch, rated 250 amps at 100% duty cycle.

PTW-18

Water-cooled TIG torch, rated 350 amps at 100% duty cycle.

WHAT YOU NEED TO GET STARTED

Along with your Pro-Torch TIG torch, you may need to purchase the following accessories to begin welding:

TIG-Torch Adapter

A variety of adapters exist to connect to a variety of output terminals such as 1/2 in. (12.7mm) studs, Twist-Mate™ output terminals and Precision TIG-style connectors.

Hook-Up Kit

(for machines with 1/2" output terminals)
These convenience kits contain the necessary hoses and accessories to connect between your gas regulator, power source and water supply. Three are available: one for water-cooled torches, one for air-cooled torches with a handle valve and one for air-cooled torches without a handle valve.

Collets

These hold the tungsten firmly in your torch. They are purchased according to the tungsten size and must be used with the proper corresponding collet bodies, or gas lens collet bodies.

Collet Bodies and Gas Lens Collet Bodies

Collet bodies hold the collet and tungsten in place. Gas lens collet bodies are used in conjunction with gas lenses when precise control of shielding gas flow is required.

Alumina Nozzles

These nozzles, made of high temperature ceramic material, protect the collet body and direct the gas flow to the weld. Choose them according to the chart on this page, for your specific application.

Back Cap

Each torch comes with one back cap which is sufficient for most applications. PTA 9 and PTW-20 torches include a medium back cap. PTA 17, 26 and PTW-18 torches include a long back cap. However, optional longer or shorter back caps are available for each torch.

Tungsten Electrode

Your welding supplier can provide you with the proper electrode for your application. Use the chart listed below, as a guide for ordering the appropriate tungsten.

Magnum Parts Kits

Magnum Parts Kits conveniently provide all the torch accessories you need to start welding. Parts Kits provide collets, collet bodies, a back cap, alumina nozzles and tungstens in a variety of sizes, all packaged in an easy to carry reclosable box.

TYPICAL CURRENT RANGES FOR TUNGSTEN ELECTRODES (1)

Tungsten Electrode Diameter in. (mm)	DCEN(-) 1%, 2% Thoriated Tungsten	DCEP(+) 1%, 2% Thoriated Tungsten	AC				Alumina Nozzle Size
			Balanced Wave		Unbalanced Wave		
			Pure Tungsten	1%, 2% Thoriated Tungsten Zirconiated	Pure Tungsten	1%, 2% Thoriated Tungsten Zirconiated	
0.020 (0.5)	5-20	(2)	10-20	5-20	5-15	5-20	4,5,6
0.040 (1.0)	15-80	(2)	20-30	20-60	10-60	15-80	4,5,6
1/16 (1.6)	70-150	10-20	30-80	60-120	50-100	70-150	5,6
3/32 (2.4)	150-250	15-30	60-130	100-180	100-160	140-235	6,7,8
1/8 (3.2)	250-400	25-40	100-180	160-250	150-210	225-325	6,7,8
5/32 (4.0)	400-500	40-55	160-240	200-320	200-275	300-400	8,10

(1) With argon gas.

(2) DCEP (+) is not commonly used in these sizes.



HOOK-UP KITS (FOR USE WITH OLDER STYLE MACHINES HAVING 1/2" OUTPUT STUDS)

These kits contain the hoses and accessories to connect between your gas regulator, power source and water supply. Three are available: one for water-cooled torches, one for air-cooled torches with a handle valve and one for air-cooled torches without a handle valve.

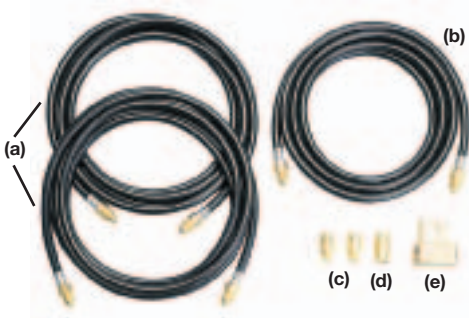

KP504
(For PTW-18 and PTW-20)



KP505
(For PTA-9, PTA-9F, PTA-17, PTA-17F, PTA-26 and PTA-26F)



KP506
(For PTA-17V and PTA-26V)

Item	Part No. (Industry Ref.)	Description	Qty.
a	S19558-4 (40V76)	Water Hose 12.5 ft. (3.8m)	2
b	S19558-1 (40V77)	Gas Hose 12.5ft. (3.8m)	1
c	S19558-5	Water Adapter Fittings 5/8ft. (15.8mm)	2
d	S19558-6 (11N18)	Water Hose Coupler	1
e	K1893-1 (45V11)	Power Cable Adapter	1

Item	Part No. (Industry Ref.)	Description	Qty.
a	S19558-2	Gas Hose 18 in. (457mm) from solenoid valve to power cable adapter	1
b	S19558-1 (40V77)	Gas Hose 12.5 ft. (3.8m)	1

Item	Part No. (Industry Ref.)	Description	Qty.
a	S19558-1 (40V77)	Gas Hose 12.5 in.(3.8m) with 5/8-18 right hand male fittings	1

TIG TORCH CONNECTION ADAPTERS

These adapters connect the TIG torch cables to the power source. May be required for certain torches.

Description	Part No. (Industry Ref.)	Figure
For Precision TIG power sources		
PTA-26 one piece power cable	K2166-1	9
PTA-9, -17 one piece power cable	K2166-3	9
PTA-9, -17, -26 two piece power cable	K2166-2	9
PTW-18-20	No adapter required	
For power sources with 1/2" output terminals (Including the TIG Module)		
PTW-18 PTW-20	K1893-1 (45V11)	4
PTA-26 PTA-26V	K1893-2 (45V62)	5 & 6
PTA-9, -17	K1893-3 (105Z57)	5 & 6
PTA-9V, -17V, -26V two piece power cable	No adapter required	7
PTA-9, -17, -26 two piece power cable	No adapter required	8
For power sources with Twist-Mate™ with gas pass through		
PTA-9, -17	K1622-1	3
PTW-18, -20	K1622-4	1
PTA-26	K1622-3	3
For power sources with Twist-Mate™ power and separate gas		
PTA-9FV, -17V, -17FV	K960-1	2



Figure 1

Water Cooled Torch Connection to Power Source with Combined Gas/Power Twist-Mate Connectors

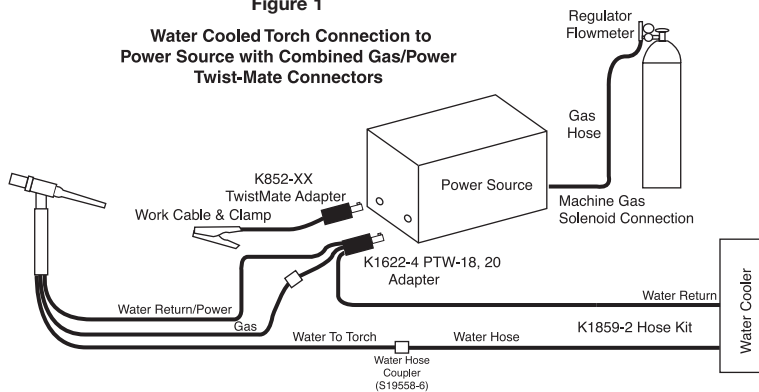

Figure 2

1-Piece Air Cooled Torch Connection to Machines with Twist-Mate Power Connector and Separate Gas

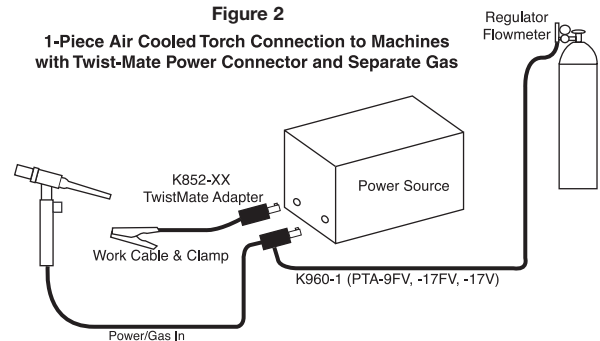

Figure 3

1-Piece Air Cooled Torch Connection to Machines with Combined Gas/Power Twist-Mate Connectors

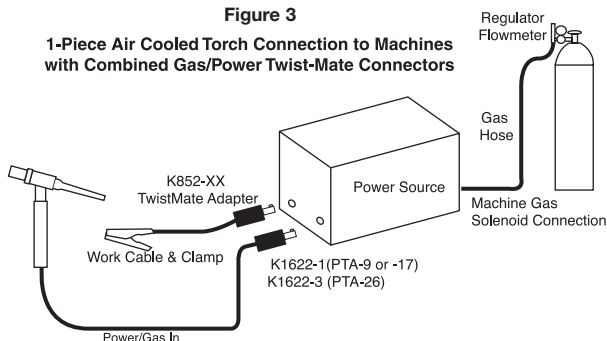
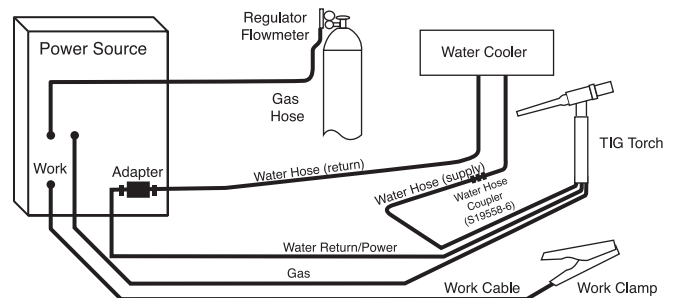

Figure 4

Water Cooled TIG Torch - Water Cooler



TIG TORCH CONNECTION ADAPTERS

Figure 5

Power Source Gas Solenoid, 1 Piece Power Cable

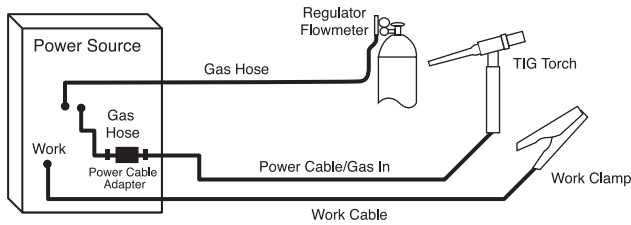

Figure 6

Torch Gas Valve, 1 Piece Power Cable

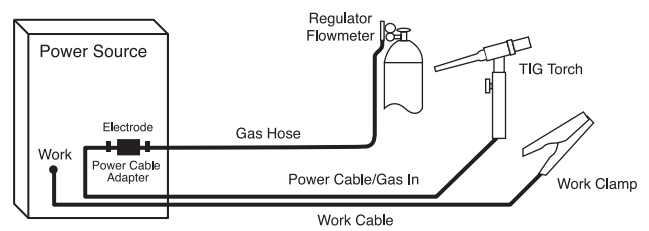

Figure 7

Torch Gas Valve, 2 Piece Power Cable

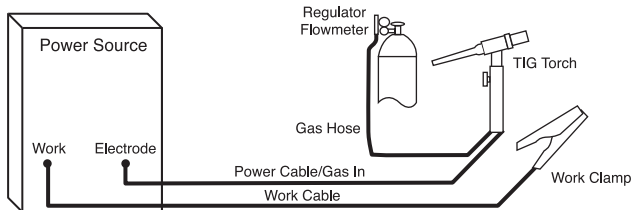

Figure 8

Power Source Gas Solenoid, 2 Piece Power Cable

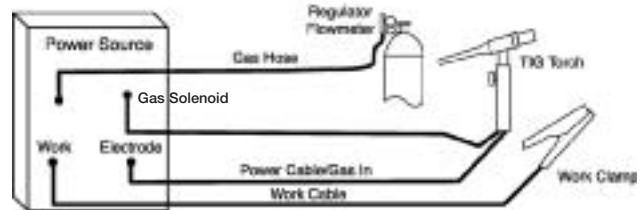
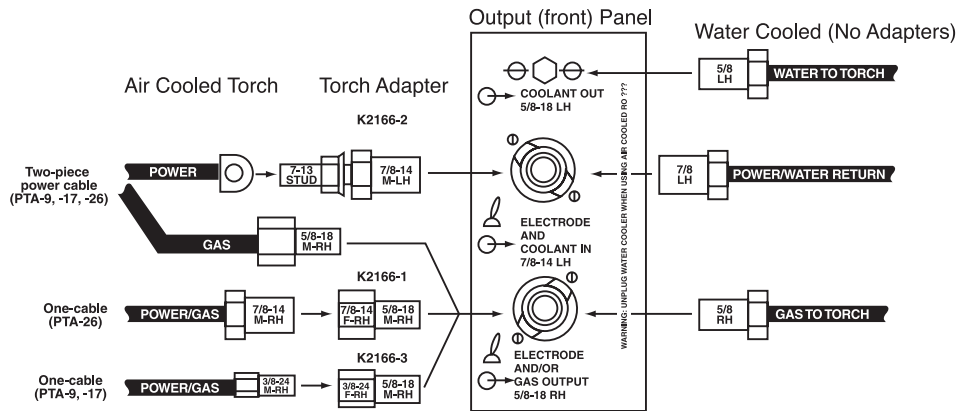

Figure 8

Precision TIG 275 & 375



PARTS KITS

Magnum® Parts Kits provide all the torch accessories you need to start welding. Parts Kits provide collets, collet bodies, a back cap, alumina nozzles and tungstens in a variety of sizes, all packaged in an easy to carry reclosable box. Four kits are available.

KP507 (For PTA-9 Series Air Cooled Torches)



Qty	Part No.	Industry Ref. No.	Description	Size in. (mm)
1	KP2035-4B1	41V24	Back Cap	Long
1	KP2029-2B1	13N21	Collet	.040 (1.0)
1	KP2029-3B1	13N22	Collet	1/16 (1.6)
1	KP2031-2B1	13N26	Collet Body	.040 (1.0)
1	KP2031-3B1	13N27	Collet Body	1/16 (1.6)
1	KP2017-1B1	13N08	Alumina Nozzle	1/4 (6.0)
1	KP2017-2B1	13N09	Alumina Nozzle	5/16 (8.0)
1	KP2017-3B1	13N10	Alumina Nozzle	3/8 (10.0)
1			Tungsten Electrode, 2% Thoriated	.040"x7.0" (1.0 x 178mm)
1			Tungsten Electrode, 2% Thoriated	1/16"x7.0" (1.6 x 178mm)

PARTS KITS

KP508 (For PTA-17 Series Torches)



Qty.	Part No.	Industry Ref. No.	Description	Size in. (mm)
1	KP2036-2B1	57Y04	Back Cap	Short
1	KP2030-2B1	10N22	Collet	.040 (1.0)
1	KP2030-3B1	10N23	Collet	1/16 (1.6)
1	KP2030-4B1	10N24	Collet	3/32 (2.4)
1	KP2032-2B1	10N30	Collet Body	.040 (1.0)
1	KP2032-3B1	10N31	Collet Body	1/16 (1.6)
1	KP2032-4B1	10N32	Collet Body	3/32 (2.4)
1	KP2016-6B1	10N50	Alumina Nozzle	1/4 (6.0)
1	KP2016-5B1	10N49	Alumina Nozzle	5/16 (8.0)
1	KP2016-4B1	10N48	Alumina Nozzle	3/8 (10.0)
1	Tungsten Electrode, 2% Thoriated			.040"x7.0" (1.0 x 178mm)
1	Tungsten Electrode, 2% Thoriated			1/16"x7.0" (1.6 x 178mm)
1	Tungsten Electrode, 2% Thoriated			3/32"x7.0" (2.4 x 178mm)

KP509 (For PTW-18 & PTA-26 Series Torches)



Qty.	Part No.	Industry Ref. No.	Description	Size in. (mm)
1	KP2036-2B1	57Y04	Back Cap	Short
1	KP2030-3B1	10N23	Collet	1/16 (1.6)
1	KP2030-4B1	10N24	Collet	3/32 (2.4)
1	KP2030-5B1	10N25	Collet	1/8 (3.2)
1	KP2032-3B1	10N31	Collet Body	1/16 (1.6)
1	KP2032-4B1	10N32	Collet Body	3/32 (2.4)
1	KP2032-5B1	10N28	Collet Body	1/8 (3.2)
1	KP2016-5B1	10N49	Alumina Nozzle	5/16 (8.0)
1	KP2016-4B1	10N48	Alumina Nozzle	3/8 (10.0)
1	KP2016-2B1	10N46	Alumina Nozzle	1/2 (12.5)
1	Tungsten Electrode, 2% Thoriated			1/16"x7.0" (1.6 x 178mm)
1	Tungsten Electrode, 2% Thoriated			3/32"x7.0" (2.4 x 178mm)
1	Tungsten Electrode, 2% Thoriated			1/8"x7.0" (3.2 x 178mm)

KP510 (For PTW-20 Series Torches)



Qty.	Part No.	Industry Ref. No.	Description	Size in. (mm)
1	KP2035-4B1	41V24	Back Cap	Long
1	KP2029-3B1	13N22	Collet	1/16 (1.6)
1	KP2029-4B1	13N23	Collet	3/32 (2.4)
1	KP2029-5B1	13N24	Collet	1/8 (3.2)
1	KP2031-3B1	13N27	Collet Body	1/16 (1.6)
1	KP2031-4B1	13N28	Collet Body	3/32 (2.4)
1	KP2031-5B1	13N29	Collet Body	1/8 (3.2)
1	KP2017-2B1	13N09	Alumina Nozzle	5/16 (8.0)
1	KP2017-3B1	13N10	Alumina Nozzle	3/8 (10.0)
1	KP2017-4B1	13N11	Alumina Nozzle	7/16 (11.0)
1	Tungsten Electrode, 2% Thoriated			1/16"x7.0" (1.6 x 178mm)
1	Tungsten Electrode, 2% Thoriated			3/32"x7.0" (2.4 x 178mm)
1	Tungsten Electrode, 2% Thoriated			1/8"x7.0" (3.2 x 178mm)

KP2414-1 Gas Lens Parts Kit (For PTA-9 or PTW-20 Series Torches)



Parts shown are not actual size.

Qty.	Part No.	Industry Ref. No.	Description	Size in. (mm)
1	KP2035-4B1	41V24	Back Cap	Long
1	KP2029-2B1	13N21	Collet	.040
1	KP2029-3B1	13N22	Collet	1/16"
1	KP2029-4B1	13N23	Collet	3/32"
1	KP2033-2B1	45V42	Gas Lens Collet Body	.040
1	KP2033-3B1	45V43	Gas Lens Collet Body	1/16"
1	KP2033-4B1	45V44	Gas Lens Collet Body	3/32"
1	KP2019-2B1	53N59	Gas Lens Nozzle	#5
1	KP2019-3B1	53N60	Gas Lens Nozzle	#6
1	KP2019-4B1	53N61	Gas Lens Nozzle	#7
1	Tungsten Electrode, 2% Thoriated			.040
1	Tungsten Electrode, 2% Thoriated			1/16"
1	Tungsten Electrode, 2% Thoriated			3/32"

EXPENDABLE PARTS

Collet



FOR PTA-9 SERIES & PTW-20 SERIES TORCHES

Name	Part No.	Industry Ref. No.	Tungsten Diameter in. (mm)
Collet	KP2029-1B1	13N20	.020 (0.5)
	KP2029-2B1	13N21	.040 (1.0)
	KP2029-3B1	13N22	1/16 (1.6)
	KP2029-4B1	13N23	3/32 (2.4)
	KP2029-5B1	13N24	1/8 (3.2)

FOR PTA-17 SERIES, PTA-26 SERIES & PTW-18 SERIES TORCHES

Name	Part No.	Industry Ref. No.	Tungsten Diameter in. (mm)
Collet	KP2030-1B1	10N21	.020 (0.5)
	KP2030-2B1	10N22	.040 (1.0)
	KP2030-3B1	10N23	1/16 (1.6)
	KP2030-4B1	10N24	3/32 (2.4)
	KP2030-5B1	10N25	1/8 (3.2)
	KP2030-6B1	54N20	5/32 (4.0)

Collet Body



FOR PTA-9 SERIES & PTW-20 SERIES TORCHES

Name	Part No.	Industry Ref. No.	Tungsten Diameter in. (mm)
Collet Body	KP2031-1B1	13N25	.020 (0.5)
	KP2031-2B1	13N26	.040 (1.0)
	KP2031-3B1	13N27	1/16 (1.6)
	KP2031-4B1	13N28	3/32 (2.4)
	KP2031-5B1	13N29	1/8 (3.2)

FOR PTA-17 SERIES, PTA-26 SERIES & PTW-18 SERIES TORCHES

Name	Part No.	Industry Ref. No.	Tungsten Diameter in. (mm)
Collet Body	KP2032-1B1	10N29	.020 (0.5)
	KP2032-2B1	10N30	.040 (1.0)
	KP2032-3B1	10N31	1/16 (1.6)
	KP2032-4B1	10N32	3/32 (2.4)
	KP2032-5B1	10N28	1/8 (3.2)
	KP2032-6B1	406488	5/32 (4.0)

Alumina Nozzles



FOR PTA-9 SERIES & PTW-20 SERIES TORCHES

Name	Part No.	Industry Ref. No.	Nozzle Orifice Dia. in. (mm)	Size (16th of an inch)	Length
Alumina Nozzle	KP2017-1B1	13N08	1/4 (6)	4	
	KP2017-2B1	13N09	5/16 (8)	5	
	KP2017-3B1	13N10	3/8 (10)	6	1-5/32"
	KP2017-4B1	13N11	7/16 (11)	7	(29.3mm)
	KP2017-5B1	13N12	1/2 (12.5)	8	
	KP2017-6B1	13N13	5/8 (16)	10	

FOR PTA-17 SERIES, PTA-26 SERIES & PTW-18 SERIES TORCHES

Name	Part No.	Industry Ref. No.	Nozzle Orifice Dia. in. (mm)	Size (16th of an inch)	Length
Alumina Nozzle	KP2016-6B1	10N50	1/4 (6)	4	
	KP2016-5B1	10N49	5/16 (8)	5	
	KP2016-4B1	10N48	3/8 (10)	6	1-27/32"
	KP2016-3B1	10N47	7/16 (11)	7	(46.8mm)
	KP2016-2B1	10N46	1/2 (12.5)	8	
	KP2016-1B1	10N45	5/8 (16)	10	

Gas Lens Collet Bodies



FOR PTA-9 SERIES & PTW-20 SERIES TORCHES

Name	Part No.	Industry Ref. No.	Tungsten Diameter in. (mm)
Gas Lens Collet Body	KP2033-1B1	45V41	.020 (0.5)
	KP2033-2B1	45V42	.040 (1.0)
	KP2033-3B1	45V43	1/16 (1.6)
	KP2033-4B1	45V44	3/32 (2.4)
	KP2033-5B1	45V45	1/8 (3.2)

FOR PTA-17 SERIES, PTA-26 SERIES & PTW-18 SERIES TORCHES

Name	Part No.	Industry Ref. No.	Tungsten Diameter in. (mm)
Gas Lens Collet Body (1)	KP2034-1B1	45V29	.020 (0.5)
	KP2034-2B1	45V24	.040 (1.0)
	KP2034-3B1	45V25	1/16 (1.6)
	KP2034-4B1	45V26	3/32 (2.4)
	KP2034-5B1	45V27	1/8 (3.2)
	KP2034-6B1	45V28	5/32 (4.0)

Alumina Gas Lens Nozzles



FOR PTA-9 SERIES & PTW-20 SERIES TORCHES

Name	Part No.	Industry Ref. No.	Nozzle Orifice Dia. in. (mm)	Size (16th of an inch)	Length
Alumina Gas Lens Nozzle	KP2019-1B1	53N58	1/4 (6)	4	
	KP2019-2B1	53N59	5/16 (8)	5	
	KP2019-3B1	53N60	3/8 (10)	6	1"
	KP2019-4B1	53N61	7/16 (11)	7	(25.4mm)

FOR PTA-17 SERIES, PTA-26 SERIES & PTW-18 SERIES TORCHES

Name	Part No.	Industry Ref. No.	Nozzle Orifice Dia. in. (mm)	Size (16th of an inch)	Length
Alumina Gas Lens Nozzle (2)	KP2018-5B1	54N18	1/4 (6)	4	
	KP2018-4B1	54N17	5/16 (8)	5	
	KP2018-3B1	54N16	3/8 (10)	6	1-5/8"
	KP2018-2B1	54N15	7/16 (11)	7	(41.3mm)
	KP2018-1B1	54N14	1/2 (12.5)	8	
	KP2018-6B1	54N19	11/16 (17)	Short	1-1/8" (28.5mm)

(1) Note: Use of these Gas Lens Collet Bodies requires a KP2037-3B1 (54N01) Gas Lens Insulator

(2) Note: Use of these Alumina Gas Lens Nozzles requires a KP2037-3B1 (54N01) Gas Lens Insulator.

Back Caps



FOR PTA-9 SERIES & PTW-20 SERIES TORCHES

Name	Part No.	Industry Ref. No.	Size
Back Caps	KP2035-1B1	41V33	Short
	KP2035-2B1	41V35	Medium
	KP2035-4B1	41V24	Long

FOR PTA-17 SERIES, PTA-26 SERIES & PTW-18 SERIES TORCHES

Name	Part No.	Industry Ref. No.	Size
Back Caps	KP2036-1B1	57Y02	Long
	KP2036-2B1	57Y04	Short

Parts shown are not actual size.

REPLACEMENT PARTS

PTW-18, -20 SERIES WATER-COOLED REPLACEMENT PARTS

Item No.	Part No.	Industry Ref. No.	Description
1	S19261-1	—	Torch body with gaskets, PTW-18
1	S19262-1	—	Torch body with gaskets, PTW-20
2	S19511-2	—	Torch Handle, PTW-18
2	S19511-1	—	Torch Handle, PTW-20
3	S19512-17	40V75	Gas Hose, 12.5' (3.8m), PTW-18
3	S19512-20	40V30	Gas Hose, 25' (7.6m), PTW-18
3	S19512-11	45V09	Gas Hose, 12.5' (3.8m), PTW-20
3	S19512-14	45V10	Gas Hose, 25' (7.6m), PTW-20
4	S19512-15	40V64	Power Cable, 12.5' (3.8m), PTW-18
4	S19512-9	45V03	Power Cable, 12.5' (3.8m), PTW-20
4	S19512-18	41V29	Power Cable, 25' (7.6m), PTW-18
4	S19512-12	45V04	Power Cable, 25' (7.6m), PTW-20
5	S19512-16	40V74	Water Hose, 12.5' (3.8m), PTW-18
5	S19512-10	45V07	Water Hose, 12.5' (3.8m), PTW-20
5	S19512-19	41V32	Water Hose, 25' (7.6m), PTW-18
5	S19512-13	45V08	Water Hose, 25' (7.6m), PTW-20
6	S19515-7	18CG	Cup Gasket, 2 pack, PTW-18
6	S19515-6	598882	Cup Gasket, 2 pack, PTW-20
7	KP2037-3B1	54N01	Gas Lens Insulation, 2 pack, PTW-18

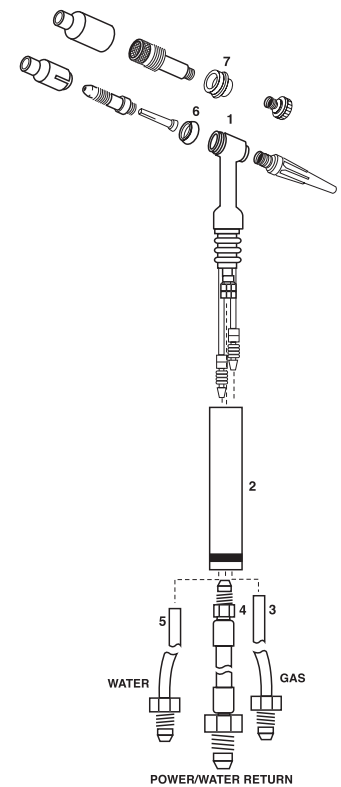

PTA-9, -17, -26 SERIES AIR-COOLED REPLACEMENT PARTS

Item No.	Part No.	Industry Ref. No.	Description
1	S19258-1	—	Torch body with gaskets, PTA-9
1	S19259-1	—	Torch body with gaskets, PTA-17
1	S19260-1	—	Torch body with gaskets, PTA-26
2	S19259-2	—	Torch body with gaskets, PTA-17V
2	S19260-2	—	Torch body with gaskets, PTA-26V
3	S24922-1	—	Torch Body with gaskets, PTA-9F
3	S24923-1	—	Torch Body with gaskets, PTA-17F
3	S24925-1	—	Torch Body with gaskets, PTA-26F
4	S19515-1	VS-2	Valve Knob with "O" Ring, PTA-17V
4	S19515-2	VS-1	Valve Knob with "O" Ring, PTA-26V
5	S19511-1	—	Torch Handle, PTA-9, 17, 17V
5	S19511-2	—	Torch Handle, PTA-26, 26V
6	S19512-2	57Y01-2	Power Cable and Gas, 2Pc, 12.5' (3.8m), PTA-9, 17
6	S19512-6	46V28-2	Power Cable and Gas, 2Pc, 12.5' (3.8m), PTA-26,
6	S19512-4	57Y03-2	Power Cable and Gas, 2Pc, 25' (7.6m), PTA-9
6	S19512-8	46V30-2	Power Cable and Gas, 2Pc, 25' (7.6m), PTA-26
7	S19512-1	57Y01R	Power Cable and Gas, 1Pc, 12.5' (3.8m), PTA-9, 17,
7	S19512-5	46V28R	Power Cable and Gas, 1Pc, 12.5' (3.8m), PTA-26, 26
7	S19512-3	57Y03R	Power Cable and Gas, 1Pc, 25' (7.6m), PTA-9, 17
7	S19512-7	46V30R	Power Cable and Gas, 1Pc, 25' (7.6m), PTA-26
7	S25811-1	57Y01BR	NEW Ultra-Flex Power Cable and Gas, 1Pc, 12.5' (3.8m), PTA-9, -17
7	S25811-2	46V28BR	NEW Ultra-Flex Power Cable and Gas, 1Pc, 12.5' (3.8m), PTA-26
8	S19515-6	598882	Cup Gasket, 2 pack, PTA-9
8a	S19515-7	18CG	Cup Gasket, 2 pack, PTA-17, 26
8a	S19515-9M	18-7	Cup Gasket, 2 pack, PTA-17F, 26F
9	KP2037-3B1	54N01	Gas Lens Insulation, 2 pack, PTA-26, 17

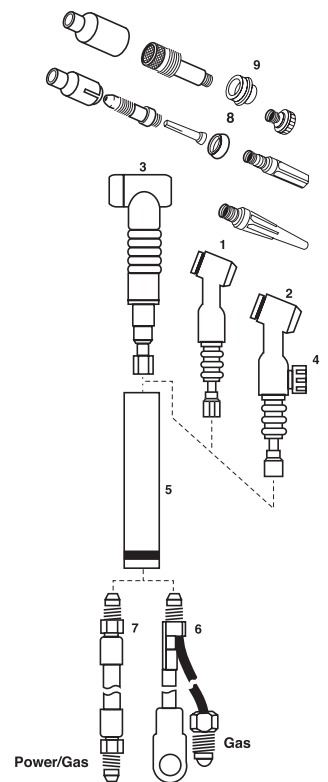

RECOMMENDED GENERAL OPTIONS

NEW!



TIG-Mate™ 9 Air-Cooled TIG Torch Starter Kit

Get everything you need for TIG welding in one complete easy-to-order kit packaged in its own portable carrying case. Includes: PTA-9 Ultra-Flex™ torch, gas lens parts kit, Harris flowmeter/regulator, Twist-Mate™ Adapter, gas hose, work clamp and cable.
Order K2413-1



Hand Amptrol™

Provides 25 ft. (7.6m) of remote current control for TIG welding. (6 pin plug connection). Velcro straps secure torch.
Order K963-3 (One size fits all Pro-Torch TIG Torches).



TIG-Mate™ 17V Air-Cooled TIG Torch Starter Pack

Get everything you need for TIG welding in one complete easy-to-order kit packaged in its own portable carrying case. Includes: PTA-17V Ultra-Flex™ torch, parts kit, Harris flowmeter/regulator, Twist-Mate™ adapter with 10 ft. gas hose, and work clamp and cable.
Order K2265-1



Zippered Cable Covers

Optional zippered cable covers are available for 12.5 ft. (3.8m) and 25 ft. (7.6m) torches which protect the torch cables in high abrasion applications.
Order K918-1 (12.5 ft.)
Order K918-2 (25 ft.)



TIG-Mate™ 17 Air-Cooled TIG Torch Starter Pack

Get everything you need for TIG welding in one complete easy-to-order kit packaged in its own portable carrying case. Includes: PTA-17 Ultra-Flex™ torch, parts kit, Harris flowmeter/regulator, 10 ft. gas hose, Twist-Mate™ adapter, and work clamp and cable.
Order K2266-1



Foot Amptrol™

Provides 25 ft. (7.6m) of remote current control for TIG welding. (6 pin plug connection).
Order K870



TIG-Mate™ 20 Water-Cooled TIG Torch Starter Pack

Get everything you need for TIG welding in one complete easy-to-order kit packaged in its own portable carrying case. Includes: PTW-20 torch, parts kit, Harris flowmeter/regulator, Twist-Mate™ adapter, 10 ft. gas hose, water hose coupler and water hoses, work clamp and cable.
Order K2267-1



Arc Start Switch

May be used in place of the Foot or Hand Amptrol. Comes with a 25 ft. (7.6m) cable. Attaches to the TIG torch for convenient finger control to start and stop the weld cycle at the current set on the machine.
Order K814

NEW!

15 Foot TIG Torch Extension

This extension has a male Twist-Mate connector on the power source side and a female connector on the torch side. Allows you to extend your torch length quickly for an extra 15 feet of reach. Rated 200A 60% duty cycle.
Order K2412-1

CUSTOMER ASSISTANCE POLICY

The business of The Lincoln Electric Company is manufacturing and selling high quality welding equipment, consumables, and cutting equipment. Our challenge is to meet the needs of our customers and to exceed their expectations. On occasion, purchasers may ask Lincoln Electric for advice or information about their use of our products. We respond to our customers based on the best information in our possession at that time. Lincoln Electric is not in a position to warrant or guarantee such advice, and assumes no liability, with respect to such information or advice. We expressly disclaim any warranty of any kind, including any warranty of fitness for any customer's particular purpose, with respect to such information or advice. As a matter of practical consideration, we also cannot assume any responsibility for updating or correcting any such information or advice once it has been given, nor does the provision of information or advice create, expand or alter any warranty with respect to the sale of our products.

Lincoln Electric is a responsive manufacturer, but the selection and use of specific products sold by Lincoln Electric is solely within the control of, and remains the sole responsibility of the customer. Many variables beyond the control of Lincoln Electric affect the results obtained in applying these types of fabrication methods and service requirements.

Subject to Change – This information is accurate to the best of our knowledge at the time of printing. Please refer to www.lincolnelectric.com for any updated information.

ORDERING INFORMATION
PTA-9, -17, -26 SERIES AIR-COOLED TIG TORCHES

Product Number	Rated Amperage	Duty Cycle	Cable Length ft. (m)	Number of Cables	Tungsten Range
PTA-9 K1781-1	125	60%	12.5 (3.8)	1	.020 - 1/8 in. (0.8 - 3.2 mm)
K1781-2	125		12.5 (3.8)	2	
K1781-3	125		25.0 (7.6)	1	
K1781-4	125		25.0 (7.6)	2	
PTA-9F K1781-6	125	60%	25.0 (7.6)	1	.020 - 1/8 in. (0.8 - 3.2 mm)
PTA-9FV K1781-7	125	60%	25.0 (7.6)	1	.020 - 1/8 in. (0.8 - 3.2 mm)
PTA-9 Ultra-Flex K1781-8	125	60%	12.5 (3.8)	1	.020 - 1/8 (0.8 - 3.2 mm)
NEW! PTA-9F Ultra-Flex(1) Pkg. K1781-9					
PTA-17 K1782-1	150	60%	12.5 (3.8)	1	.020 - 5/32 in. (0.5 - 4.0 mm)
K1782-2	150		12.5 (3.8)	2	
K1782-3	150		25.0 (7.6)	1	
K1782-4	150		25.0 (7.6)	2	
PTA-17F K1782-10	150	60%	25.0 (7.6)	1	.020 - 5/32 in. (0.5 - 4.0 mm)
PTA-17FV K1782-11	150	60%	25.0 (7.6)	1	.020 - 5/32 in. (0.5 - 4.0 mm)
PTA-17V K1782-6	150	60%	12.5 (3.8)	1	.020 - 5/32 in. (0.5 - 4.0 mm)
K1782-7	150		12.5 (3.8)	2	
K1782-8	150		25.0 (7.6)	1	
K1782-9	150		25.0 (7.6)	2	
PTA-17 Ultra-Flex K1782-12	150	60%	12.5 (3.8)	1	.020 - 5/32 (0.5 - 4.0 mm)
PTA-26 K1783-1	200	60%	12.5 (3.8)	1	.020 - 5/32 in. (0.5 - 4.0 mm)
K1783-2	200		12.5 (3.8)	2	
K1783-3	200		25.0 (7.6)	1	
K1783-4	200		25.0 (7.6)	2	
PTA-26F K1783-10	200	60%	25.0 (7.6)	1	.020 - 5/32 in. (0.5 - 4.0 mm)
PTA-26FV K1783-11	200	60%	25.0 (7.6)	1	.020 - 5/32 in. (0.5 - 4.0 mm)
PTA-26V K1783-6	200	60%	12.5 (3.8)	1	.020 - 5/32 in. (0.5 - 4.0 mm)
K1783-7	200		12.5 (3.8)	2	
K1783-8	200		25.0 (7.6)	1	
K1783-9	200		25.0 (7.6)	2	
NEW! PTA-26 Ultra-Flex(2) Pkg. K1783-12	200	60%	12.5 (3.8)	1	.020-5/32 in (0.5 - 4.0 mm)

(1) Pre-configured package with K1622-1 Twist-Mate adapter and 1/16" gas lens collet body, collet and gas lens installed.

(2) Pre-configured package with K1622-3 Twist-Mate adapter and 1/8" collet body, collet and gas nozzle installed.

PTW-18, -20 SERIES WATER-COOLED TIG TORCHES

Product Number	Rated Amperage	Duty Cycle	Cable Length ft. (m)	Number of Cables	Tungsten Range
PTW-18 K1784-1	350	100%	12.5 (3.8)	3	.020 - 5/32 in. (0.5 - 4.0 mm)
K1784-2			25.0 (7.6)	3	
PTW-20 K1784-3	250	100%	12.5 (3.8)	3	.020 - 1/8 in. (0.5 - 3.2 mm)
K1784-4			25.0 (7.6)	3	