

# K386 NARROW GAP DEEP GROOVE SUBMERGED ARC NOZZLE

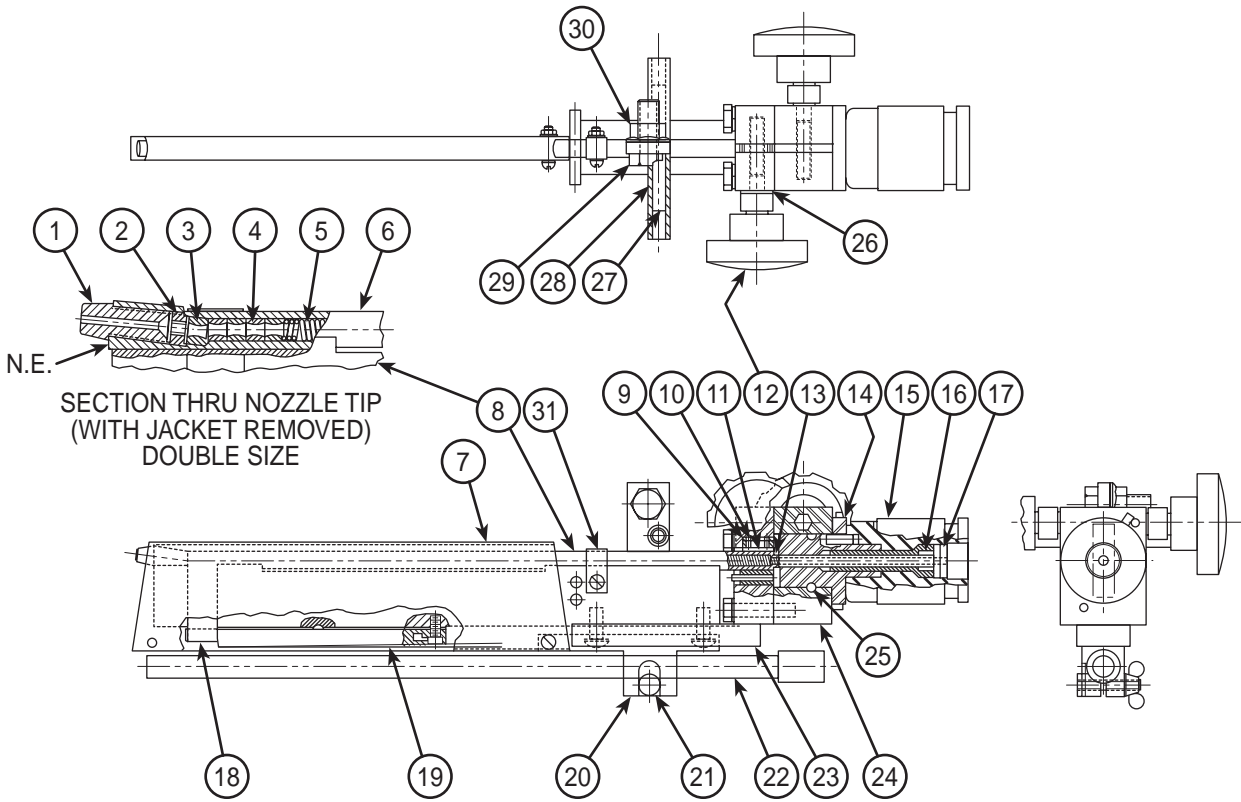

G1653  
5-18-84

# Indicates a Change This Printing												
ITEM	DESCRIPTION	PART NO.	QTY.	1	2	3	4	5	6	7	8	9
1	Nozzle Tip	T14879-3/32	1									
2	Hollow Set Screw	T12932-2	1									
3	Ceramic Insert	T12576-1	1									
4	Ceramic Insert	T12576-2	4									
5	Spring Liner	T12931-35	1									
6	Nozzle Tube Assembly	S17543	1									
7	Insulation Jacket	S17545	1									
8	Cooling Bar Assembly	S17546	1									
9	Nozzle Pivot Hub Assembly	T14891	1									
10	Set Screw	S11604-42	2									
11	Key	M8776-89	1									
12	Rotational Lock Screw Assembly	T14885	2									
13	Snap Ring	S9776-46	1									
14	Pivot Assembly	T14883	1									
15	Nozzle Insulator Assembly	S10493	1									
16	Socket Head Screw	T10570	1									
17	Nozzle Insert Assembly	S15106-1	1									
18	Pressure Belt	T14889	1									
19	Pressure Arm Assembly	T14890	1									
	Socket Head Cap Screw	T9447-56	1									
20	Flux Tube Clamp	S17542	1									
	Button Head Socket Screw	T11551-6	2									
21	Hex Head Screw	1/4-20 x 1.25	1									
	Plain Washer	S9262-23	1									
	Wing Nut	T9968-1	1									
22	Flux Tube	T14887	1									
23	Pivot Housing Arm	M14717	1									
	Lock Washer	E106-A14	3									
	Hex Head Screw	5/16-18 x 1.50	3									
24	Mounting Clamp Assembly	S17550	1									
25	Roll Pin	T9967-43	1									
26	Plain Washer	S9262-104	2									
27	Roll Pin	T9967-29	1									
28	Pivot Handle	T14939-1	2									
29	Hex Head Screw	1/2-13 x 1.25	1									
30	Flange Nut	T3960	1									
31	Nozzle Tube Strap	T14974	1									
	<b>Items Not Illustrated:</b>											
	Flux Hopper Extension Bracket	S17558	2									
	Flux Hopper Extension Pin	S17559	2									
	Extension Pin Nut	1/4-20	2									
	Flex Tube	T10642-106	1									

#